

RoHS

**Recommended P.C.B Layout**  
General Tolerance±0.05

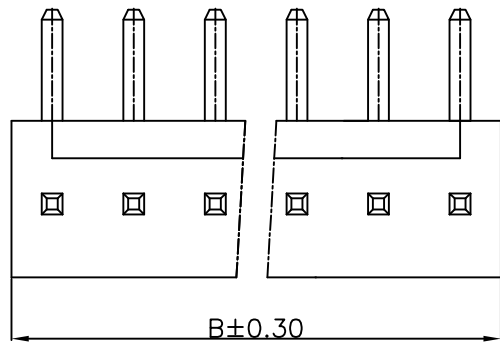
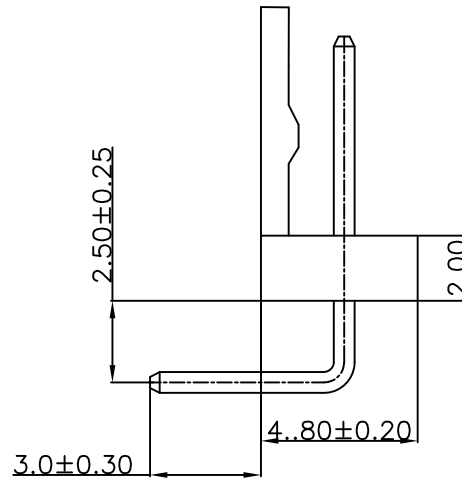
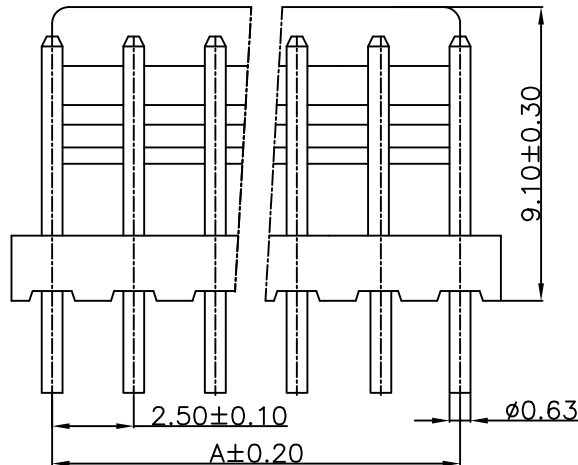
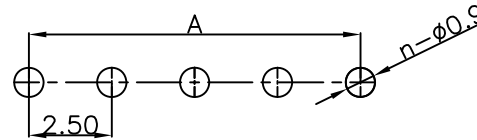

**Specification:**

- Current Rating: 2.5A AC/DC
- Voltage Rating: 250V AC/DC
- Insulation Resistance: 1000MΩ Min
- Withstanding Voltage: 800VAC Min
- Contact resistance: 20mΩ(Max).
- Operation Temperature: -25°C to +85°C

**Material:**

- Insulator (Housing): PA66 (UL94V-2)
- Contacts: Brass
- Solder: Tin Plated
- Color: Beige

**Ordering Information**

SCT2503WR - \*\* C 0 xx 102

No. of Pins See Table  
Insulation C=PA66 V2  
Package 0=PE Bag  
Color BE=Beige WT=White

10	22.50	25.00			
9	20.00	22.50			
8	17.50	20.00			
7	15.00	17.50			
6	12.50	15.00	15	35.00	37.50
5	10.00	12.50	14	32.50	35.00
4	7.50	10.00	13	30.00	32.50
3	5.00	7.50	12	27.50	30.00
2	2.50	5.00	11	25.00	27.50
Poles	A	B	Poles	A	B
	Dimensions			Dimensions	

					OPERATION	DRAW	Peng	2021.07.06	SCALE	-	 SCONDAR ELECTRONIC LIMITED
					X.X ±0.35	DESIGN			UNIT	mm	
A1	2021.07.06	Changed from SCT2503WR-xxP to SCT2503WR-xxC0xx102			X.XX ±0.25		CHECK	Lisa	2021.07.06	SIZE	
AO	2006.05.02	NEW			X.XXX ±0.15	APPROVE	Allen	2021.07.06	SHEET	1/1	
REV	DATE	MODIFICATION DESCRIPTION		CHANGE	APPROVE				PROJ.		TITLE: Dupont 2.50mm Pitch 90° Wafer Connector