

RoHS

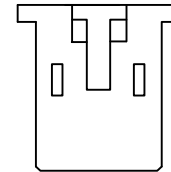
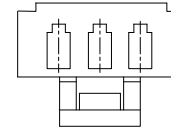
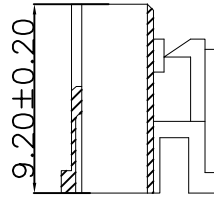
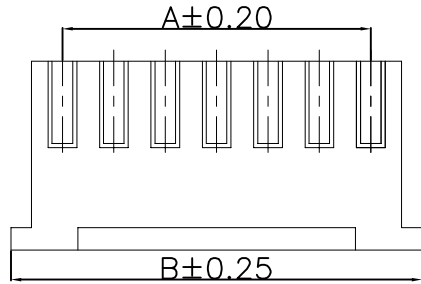

3P-16P

Specification:

- Current Rating: 3A AC/DC
- Voltage Rating: 250V AC/DC
- Insulation Resistance: 1000MΩ Min
- Withstanding Voltage: 1000VAC(1Min)
- Contact resistance: 20mΩ(Max).
- Operation Temperature: -25°C to +85°C

Material:

- Insulator (Housing): Nylon 66 (UL94V-2)
- Color: White

Ordering Information

SCT2502H - xx C WT 102

No.of Pins See Table Insulation C=PA66 V2 Color WT=White

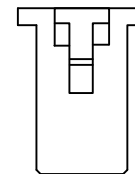
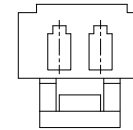
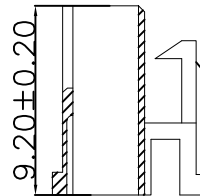
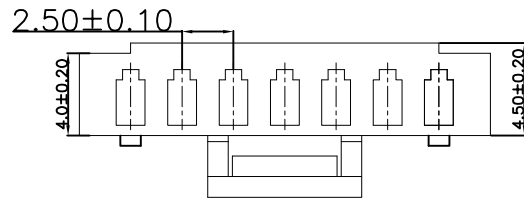

2P

10	22.50	27.50			
9	20.00	25.00			
8	17.50	22.50			
7	15.00	20.00	16	37.50	42.50
6	12.50	17.50	15	35.00	40.00
5	10.00	15.00	14	32.50	37.50
4	7.50	12.50	13	30.00	35.00
3	5.00	10.00	12	27.50	32.50
2	2.50	7.50	11	25.00	30.00
Poles	A	B	Poles	A	B
	Dimensions			Dimensions	

REV	DATE	MODIFICATION DESCRIPTION	CHANGE	APPROVE	OPERATION	DRAW	Yang	2022.06.20	SCALE	-	 SCONDAR ELECTRONIC LIMITED
					X.X	±0.35			UNIT	mm	
					X.XX	±0.25			SIZE	A4	
AO	2009.10.15	NEW			X.XXX	±0.15	Lisa	2022.06.20	SHEET	1/1	
					Angle ± 3°				PROJ.		
					DIM TOL				TITLE:	XHA 2.50mm Pitch Housing Connector	