

P.C.B LAYOUT

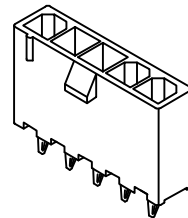
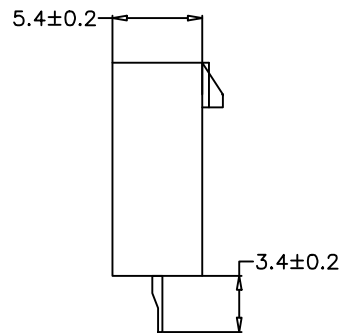

SPEOIFICATIONS

Current Rating: 7A AC,DC
 Voltage Rating: 600V AC,DC
 Temperature Range: -25°C ~ +85°C
 Contact Resistance: 10mΩ Max
 Insulation Resistance: 1000MΩ Min
 Withstanding Voltage: 1500V AC/minute
 Pin Material: Brass/Tin-plated
 Material: Nylon 66,UL94V-2

PART NO.	Dimensions	
	A	B
SCT4201WVA-02P	4.20	9.60
SCT4201WVA-03P	8.40	13.80
SCT4201WVA-04P	12.60	18.00
SCT4201WVA-05P	16.80	22.20
SCT4201WVA-06P	21.00	26.40

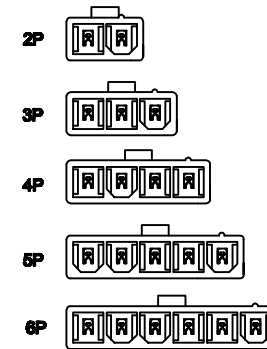

CIRCUIT SIZE LAYOUT

					OPERATION	DRAW	YANG	2016.09.09	SCALE		森康达电子有限公司 S'CONDAR ELECTRONIC LIMITED	
					~ 10 ±0.15	DESIGN			UNIT	mm		
					20 ~ 30 ±0.30	CHECK	MICKY	2016.09.09	SIZE	A4	PART NO.	SCT4201WVA-XXP
0	05/12/27	NEW			30 ~ ±0.50	APPROVE	ALLEN	2016.09.09	SHEET	1/1	TITLE:	MX4.2 1xXXP
REV	DATE	MODIFICATION DESCRIPTION	CHANGE	APPROVE	Angle ± 2'				PROJ.	◆ ←	DRAWING NO.	SCT4201
					DIM TOL							