

1 2 3 4 5 6 7 8 9 10

A

B

C

D

E

F

G

H

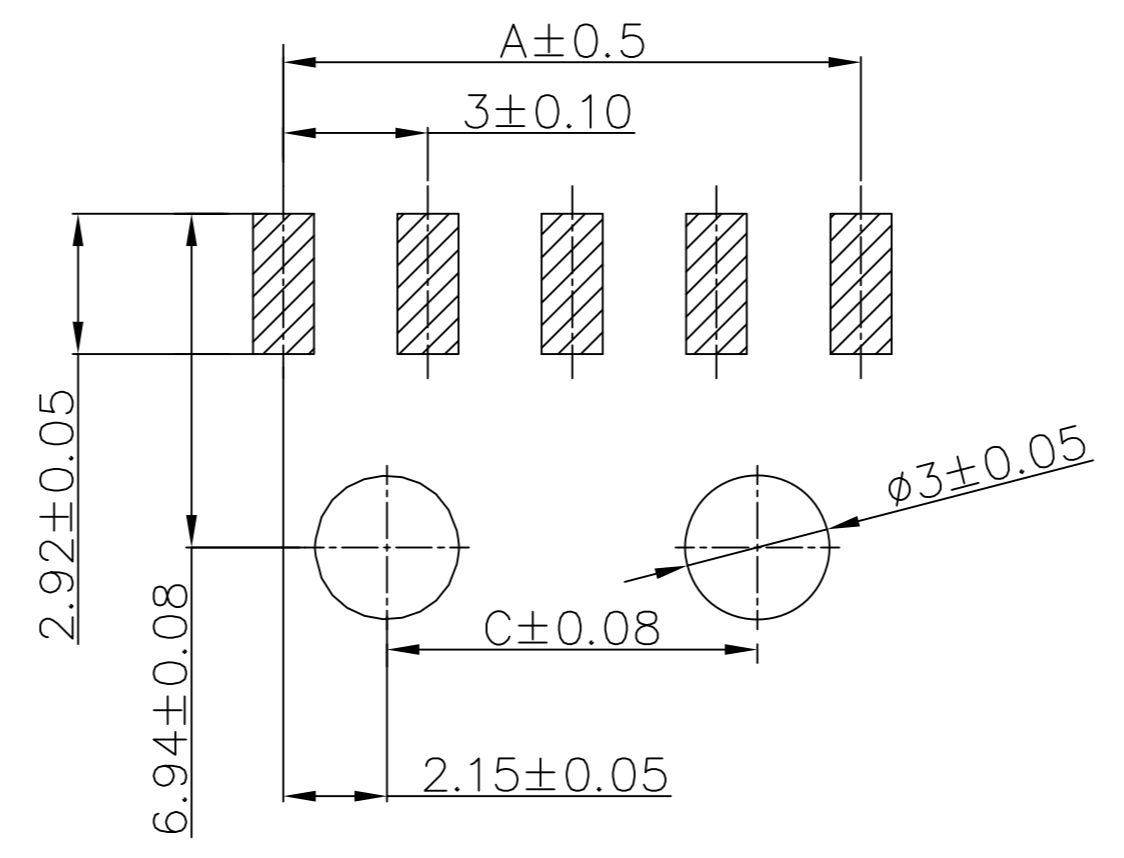
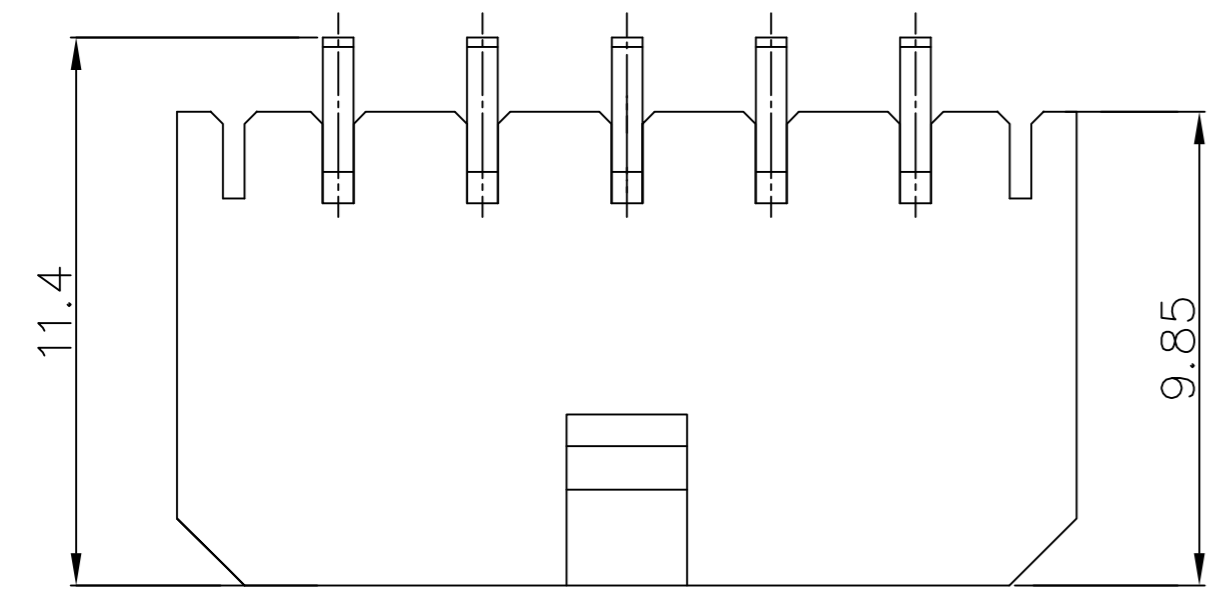

PCB LAYOUT

SPECIFICATIONS

Voltage Rating: 250V AC/DC
 Current Rating: 5A AC/DC
 Withstanding Voltage: 1000V AC/minute
 Insulation Resistance: 1000MΩ min.
 Temperature Range: -25° C - +85° C
 Contact Resistance: 20mΩ max

WAFER

Part No: SCT3001WR-S-E-XXP
 Poles: 2-12
 Material: LCP, UL94V-0
 Pin: Brass, Tin plated

PART NO.	Dimensions	
	A	B
SCT3001WR-S-2P	3.00	9.65
SCT3001WR-S-3P	6.00	12.65
SCT3001WR-S-4P	9.00	15.65
SCT3001WR-S-5P	12.00	18.65
SCT3001WR-S-6P	15.00	21.65
SCT3001WR-S-7P	18.00	24.65
SCT3001WR-S-8P	21.00	27.65
SCT3001WR-S-9P	24.00	30.65
SCT3001WR-S-10P	27.00	33.65
SCT3001WR-S-11P	30.00	36.65
SCT3001WR-S-12P	33.00	39.65

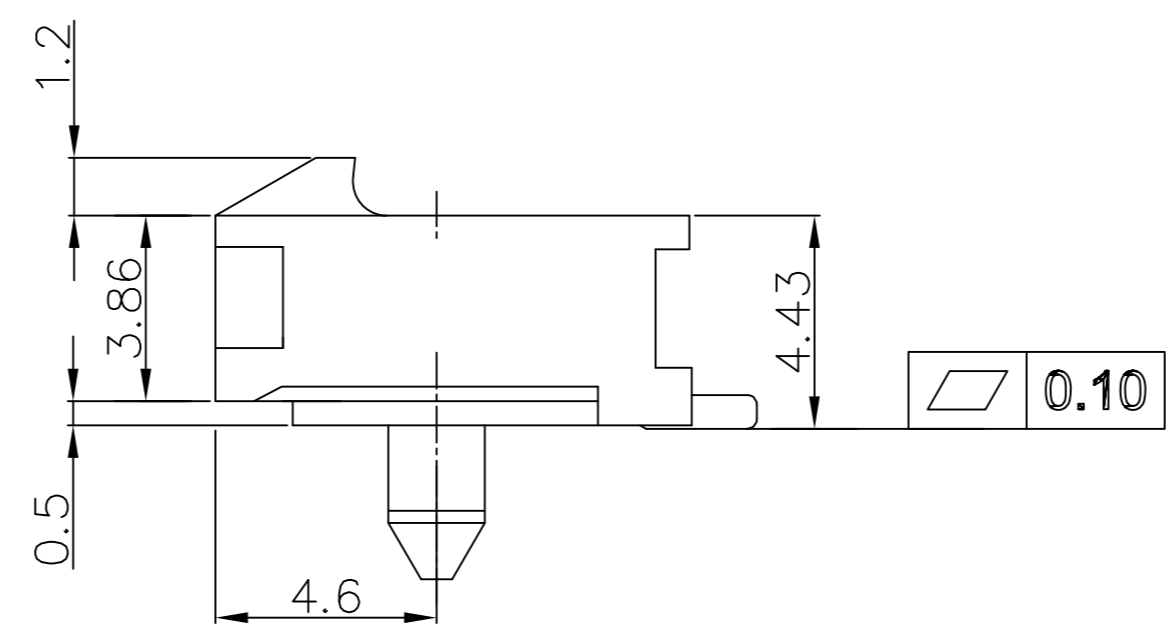
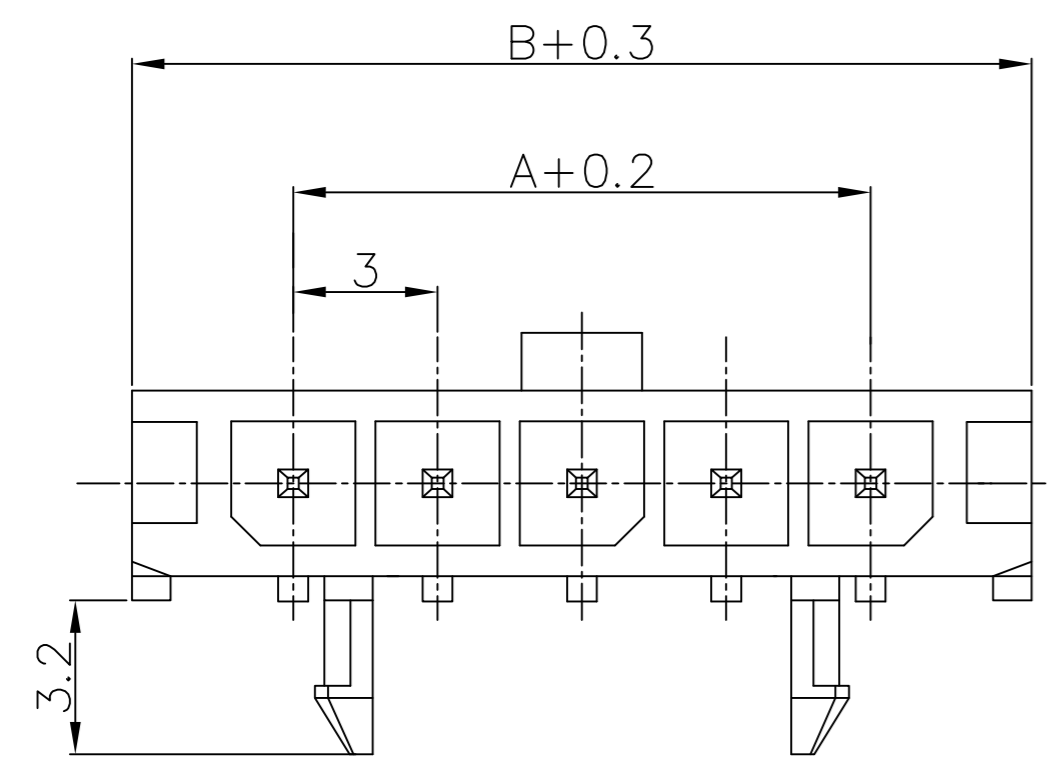

					OPERATION	DRAW	YANG	2016.04.27	SCALE	6:1	森康达电子有限公司 SCONDAR ELECTRONIC LIMITED		
					~ 10	±0.25			UNIT	mm			
					20 ~ 30	±0.30			SIZE	A4	PART NO.	SCT3001WR-S-E-XXP	
0	05/12/27		NEW		30 ~	±0.50			SHEET	1/1	TITLE:	MOLEX3.0 90C SMT WAFER	
REV	DATE		MODIFICATION DESCRIPTION	CHANGE	APPROVE	Angle DIM	± 2' TOL	APPROVE	ALLEN	2016.04.27	PROJ.	DRAWING NO.	SCT3001

1 2 3 4 5 6 7 8 9 10