

1 2 3 4 5 6 7 8 9 10

A
B
C
D
E
F
G

A
B
C
D
E
F
G

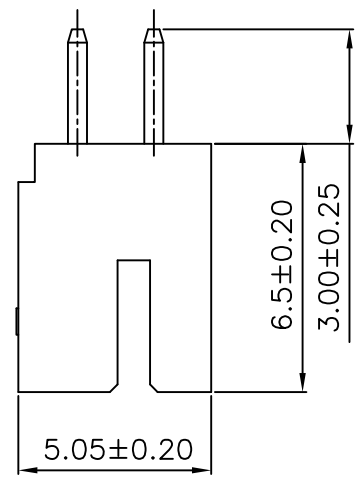
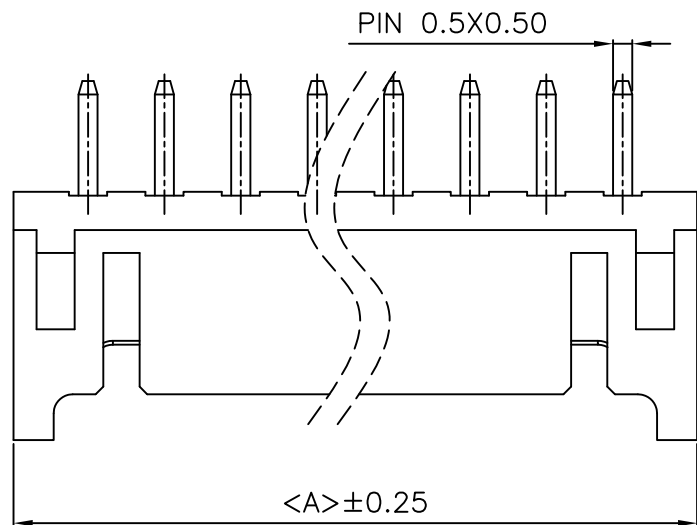

NOTES:

PART NO. : SCT2004WV-2*NPB
 Current Rating: 2A AC, DC
 Voltage Rating: 250V AC, DC
 Temperature Range: -25° C +85° C
 Contact Resistance: 20m \square max
 Insulation Resistance: \square 1000M min
 Withstanding Voltage: 800V AC/minute
 Material: PA66 UL 94V-2

PART NO.	Dimensions	
	A	B
SCT2004-WV-2X2PB	6.00	2.00
SCT2004-WV-2X3PB	8.00	4.00
SCT2004-WV-2X4PB	10.00	6.00
SCT2004-WV-2X5PB	12.00	8.00
SCT2004-WV-2X6PB	14.00	10.00
SCT2004-WV-2X7PB	16.00	12.00
SCT2004-WV-2X8PB	18.00	14.00
SCT2004-WV-2X9PB	20.00	16.00
SCT2004-WV-2X10PB	22.00	18.00
SCT2004-WV-2X11PB	24.00	20.00
SCT2004-WV-2X12PB	26.00	22.00
SCT2004-WV-2X13PB	28.00	24.00
SCT2004-WV-2X14PB	30.00	26.00
SCT2004-WV-2X15PB	32.00	28.00
SCT2004-WV-2X16PB	34.00	30.00
SCT2004-WV-2X17PB	36.00	32.00

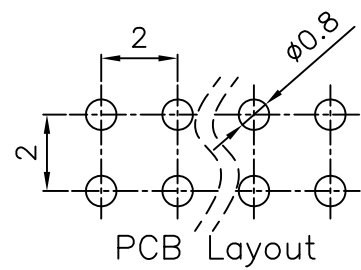
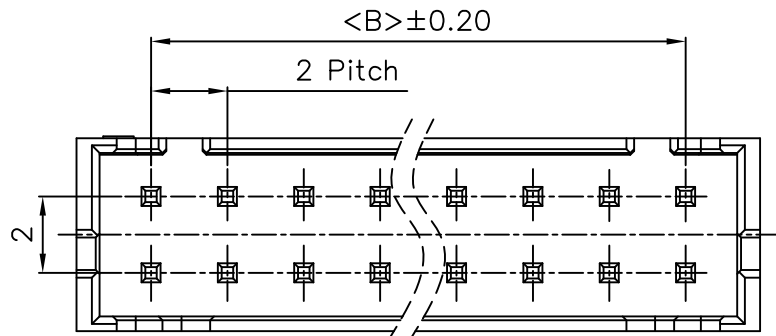

					OPERATION	DRAW			SCALE	森康达电子有限公司 SCONDAR ELECTRONIC LIMITED
					~ 10 ±0.15	DESIGN			UNIT mm	
					20 ~ 30 ±0.30	CHECK			SIZE A4	
					30 ~ ±0.50	APPROVE			SHEET 1/1	
					Angle ± 2° DIM TOL				PROJ. $\diamond \leftarrow$	
0	05/12/27	NEW							PART NO.	SCT2004WV-2xXXPB
REV	DATE	MODIFICATION DESCRIPTION	CHANGE	APPROVE					TITLE:	PHD2.0 180C WF
									DRAWING NO.	SCT2004WV

1 2 3 4 5 6 7 8 9 10