

PCB LAYOUT

SPECIFICATIONS

Voltage rating: 100V AC, DC
 Current rating: 1A, AC, DC (AWG#26)
 Withstanding Voltage: 500V AC/minute
 Insulation resistance: 500MΩ min
 Temperature range: -25°C - +85°C
 Contact resistance: 20mΩ max

WAFER

Part No: SCT1501WR-XXPB-A
 Poles: 02-16
 Material: Nylon 66, UL94V-0
 Q' TY: 1000 pcs/bag

PART NO	DIMENSION	
	A	B
SCT1501WR-02 PB	1.50	4.50
SCT1501WR-03 PB	3.00	6.00
SCT1501WR-04 PB	4.50	7.50
SCT1501WR-05 PB	6.00	9.00
SCT1501WR-06 PB	7.50	10.50
SCT1501WR-07 PB	9.00	12.00
SCT1501WR-08 PB	10.50	13.50
SCT1501WR-09 PB	12.00	15.00
SCT1501WR-10 PB	13.50	16.50
SCT1501WR-11 PB	15.00	18.00
SCT1501WR-12 PB	16.50	19.50
SCT1501WR-13 PB	18.00	21.00
SCT1501WR-14 PB	19.50	22.50
SCT1501WR-15 PB	21.00	24.00
SCT1501WR-16 PB	22.50	25.50

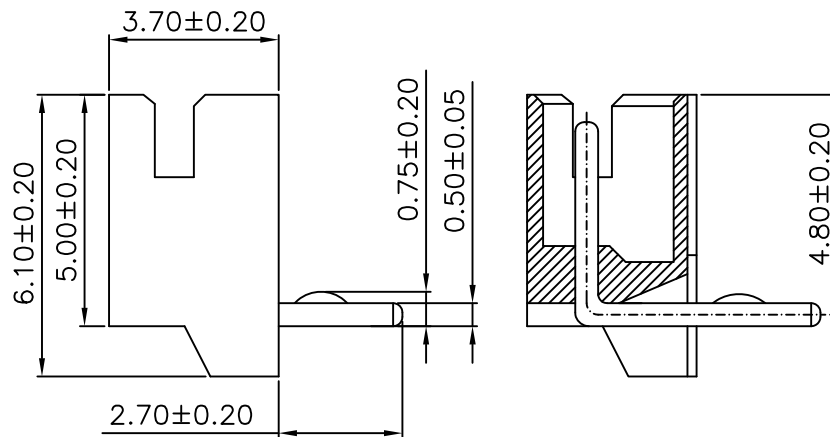
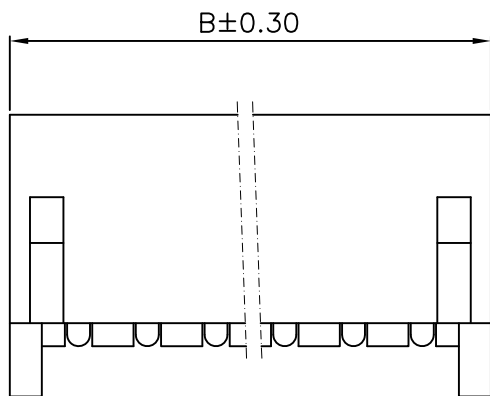

					OPERATION	DRAW	Judy.Huang	2006/05/02	SCALE		森康达电子有限公司 SCONDAR ELECTRONIC LIMITED	
					~ 10	DESIGN			UNIT	mm		
					20 ~ 30	CHECK	Micky.Liu	2006/05/02	SIZE	A4	PART NO.	SCT1501WR-XXPB
					30 ~	APPROVE	Hellen.Li	2006/05/02	SHEET	1/1	TITLE:	ZH1.5 90C WF
REV	DATE	MODIFICATION DESCRIPTION	CHANGE	APPROVE	Angle DIM				PROJ.	↻	DRAWING NO.	SCT1501