

P.C.B LAYOUT

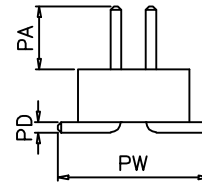

SPECIFICATIONS

Current Rating:0.75 Amps  
 Insulator Resistance:1000 Megohms Min.  
 Withstanding Voltage:300V AC/minute  
 Temperature Range: -40~+105°  
 Contact material:Brass  
 Finish: Gold or Tin plated  
 Insulator Material:Nylon6T,UL94V-0  
 Soldering Temperature:+220°C,10S max

Dimension						
H	W	PA	PB	PC	PD	PW
1.00	2.40	1.80	/	1.80	0.3	4.2
1.50	3.17	1.80	/	1.80	0.3	4.2

PH100Hxx-SMT-XxxP

Insulator height  
 1.0mm: 100  
 1.5mm: 150  
 ST: Straight 180°  
 RT: Right-angle 90°  
 SMT: Surface-Mount

No. of Circuits  
 1: Single row  
 2: Dual row

					OPERATION	DRAW	SIMON	2010.03.06	SCALE		<b>森康达电子有限公司</b> SCONDAR ELECTRONIC LIMITED	
					~ 10 ±0.15	DESIGN			UNIT	mm		
					20 ~ 30 ±0.30	CHECK	MICKY	2010.03.06	SIZE	A4	PART NO.	PH100Hxx-SMT-2xXXP
0	05/12/27	NEW			30 ~ ±0.50	APPROVE	HELLEN	2010.03.06	SHEET	1/1	TITLE	1.0mm Pin Header Dual Row Straight SMT Type
REV	DATE	MODIFICATION DESCRIPTION	CHANGE	APPROVE	Angle DIM	± 2' TOL			PROJ.	◆ ←		